



Polyester enclosures

Features

- Chemical-resistant
- Temperature-resistant
- Flame-retardant
- Use in Ex areas with a surface resistance < 10⁹ Ohm, black enclosure
- Absolutely corrosion-proof
- Seawater-proof

Description

Polyester enclosures have proven their worth in many industrial plants. They offer safe protection even when they are used under extremely unfavorable conditions, on exposure to aggressive chemical media or hard mechanical conditions. The inside base of the enclosure has at its sides, threaded bushings for the fastening of mounting rails or panels. The enclosure is mounted by means of insulated screws outside of the lid seal.

Selection chart

External dimensions in mm			Polyester black, IP 66/67	Empty enclosure Polyester grey, IP 66/67
Length (L)	Width (B)	Height (H)	➔ Order no.	➔ Order no.
80	75	55	07-5195-0800/7555	07-5194-0800/7555
110	75	55	07-5195-1100/7555	07-5194-1100/7555
160	75	55	07-5195-1600/7555	07-5194-1600/7555
190	75	55	07-5195-1900/7555	07-5194-1900/7555
122	120	90	07-5195-1221/2090	07-5194-1221/2090
122	120	120	07-5195-1221/2012	07-5194-1221/2012
220	120	90	07-5195-2201/2090	07-5194-2201/2090
160	160	90	07-5195-1601/6090	07-5194-1601/6090
160	160	120	07-5195-1601/6012	07-5194-1601/6012
260	160	90	07-5195-2601/6090	07-5194-2601/6090
360	160	90	07-5195-3601/6090	07-5194-3601/6090
560	160	90	07-5195-5601/6090	07-5194-5601/6090
200	250	120	07-5195-2002/5012	
255	250	120	07-5195-2552/5012	07-5194-2552/5012
255	250	160	07-5195-2552/5016	07-5194-2552/5016
400	250	120	07-5195-4002/5012	07-5194-4002/5012
400	250	160	07-5195-4002/5016	07-5194-4002/5016
400	405	120	07-5195-4004/0512	07-5194-4004/0512
400	405	165	07-5195-4004/0516	07-5194-4004/0516
600	250	120	07-5195-6002/0512	07-5194-6002/0512

<i>Ex enclosure</i>	<i>black</i> 07-5185-.../....	<i>grey</i> 07-5184-.../....
<p>➔ Explosion protection</p> <p>Ex protection type (according to EN 50014)</p> <p>Certification (further certifications on request)</p> <p>For group 1</p> <p>➔ Technical data</p> <p>Material</p> <p>Colour</p> <p>Lid screws (other models on request)</p> <p>Standard seal</p> <p>Mechanical resistance (according to EN 50014)</p> <p>Protection class EN 60529/IEC 60529</p>	<p>II 2G EEx e II I M2 EEx e I</p> <p>PTB 01 ATEX 1014 U UL E188224 (NEMA 4X)</p> <p>IBExU01ATEX1042 U</p> <p>glass-fiber reinforced polyester, EN 50014 surface resistance < 10⁹ Ω halogen-free</p> <p>RAL 9005, black</p> <p>stainless steel cross-head (+ -)</p> <p>EPDM -20 °C to +100 °C Silicone -55 °C to +100 °C</p> <p>impact energy 7 Nm</p> <p>IP 66/IP 67</p>	<p>II 2G EEx e II</p> <p>PTB 01 ATEX 1014 U UL E188224 (NEMA 4X)</p> <p>glass-fiber reinforced polyester, EN 50014 surface resistance >10¹² Ω halogen-free</p> <p>RAL 7000/RAL 7001, grey</p> <p>stainless steel cross-head (+ -)</p> <p>EPDM -20 °C to +100 °C Silicone -55 °C to +100 °C</p> <p>impact energy 7 Nm</p> <p>IP 66/IP 67</p>



Dimensions (mm)

The dimensions indicated on this page apply to the following polyester enclosures and distribution boxes:

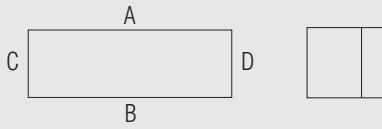

<i>IP enclosure</i>	<i>black</i>	<i>07-5195-.../...</i>	<i>EEx e distribution box</i>	<i>black</i>	<i>07-5103-.../...</i>
<i>IP enclosure</i>	<i>grey</i>	<i>07-5194-.../...</i>	<i>EEx e distribution box</i>	<i>grey</i>	<i>07-5106-.../...</i>
<i>Ex enclosure</i>	<i>black</i>	<i>07-5185-.../...</i>	<i>EEx i distribution box</i>	<i>black</i>	<i>07-5105-.../...</i>
<i>Ex enclosure</i>	<i>grey</i>	<i>07-5184-.../...</i>	<i>EEx i distribution box</i>	<i>grey</i>	<i>07-5107-.../...</i>
<i>IP distribution box</i>	<i>black</i>	<i>07-5178-.../...</i>			
<i>IP distribution box</i>	<i>grey</i>	<i>07-5177-.../...</i>			

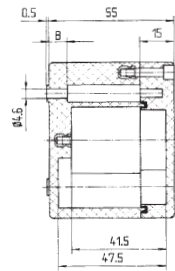
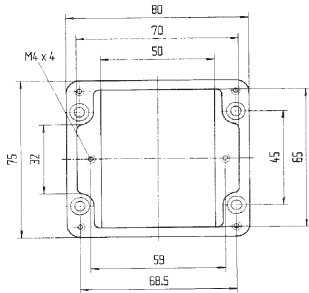

➤ Technical data

External dimensions: 80 x 75 x 55 mm

Weight: 230 g
 Material: polyester, grey, black
 Article no.: 07-51 -0800/7555

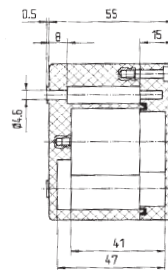
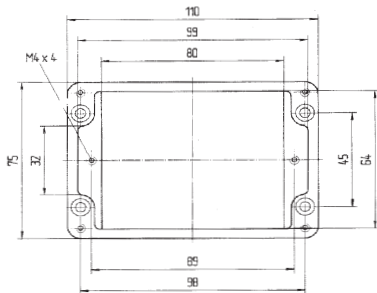

External dimensions: 110 x 75 x 55 mm

Weight: 280 g
 Material: polyester, grey, black
 Article no.: 07-51 -1100/7555

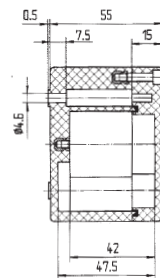
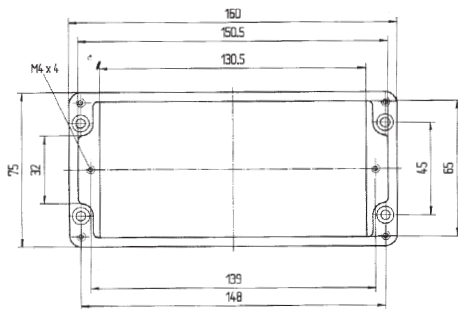

External dimensions: 160 x 75 x 55 mm

Weight: 370 g
 Material: polyester, grey, black
 Article no.: 07-51 -1600/7555

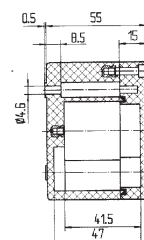
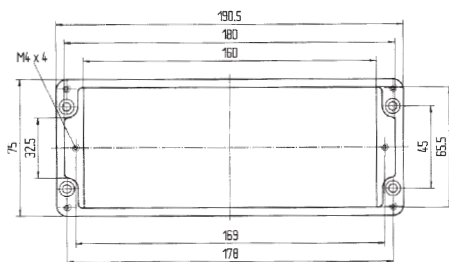

External dimensions: 190 x 75 x 55 mm

Weight: 430 g
 Material: polyester, grey, black
 Article no.: 07-51 -1900/7555



Dimensions (mm)

The dimensions indicated on this page apply to the following polyester enclosures and distribution boxes:

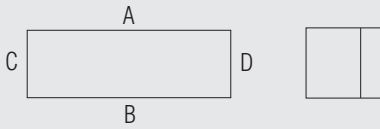

<i>IP enclosure</i>	<i>black</i>	<i>07-5195-.../...</i>	<i>EEx e distribution box</i>	<i>black</i>	<i>07-5103-.../...</i>
<i>IP enclosure</i>	<i>grey</i>	<i>07-5194-.../...</i>	<i>EEx e distribution box</i>	<i>grey</i>	<i>07-5106-.../...</i>
<i>Ex enclosure</i>	<i>black</i>	<i>07-5185-.../...</i>	<i>EEx i distribution box</i>	<i>black</i>	<i>07-5105-.../...</i>
<i>Ex enclosure</i>	<i>grey</i>	<i>07-5184-.../...</i>	<i>EEx i distribution box</i>	<i>grey</i>	<i>07-5107-.../...</i>
<i>IP distribution box</i>	<i>black</i>	<i>07-5178-.../...</i>			
<i>IP distribution box</i>	<i>grey</i>	<i>07-5177-.../...</i>			

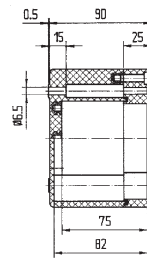
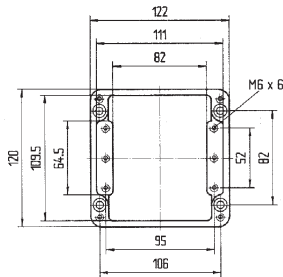

➤ Technical data

External dimensions: 122 x 120 x 90 mm

Weight: 660 g
 Material: polyester, grey, black
 Article no.: 07-51 -1221/2090

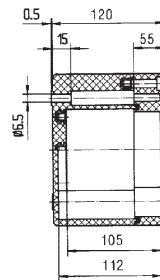
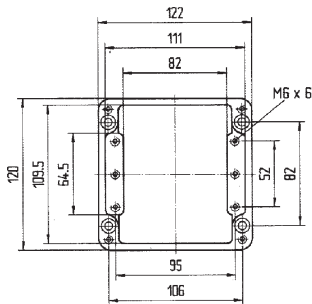

External dimensions: 122 x 120 x 120 mm

Weight: 890 g
 Material: polyester, grey, black
 Article no.: 07-51 -1221/2012

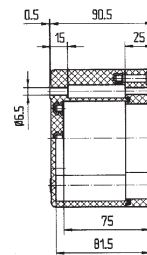
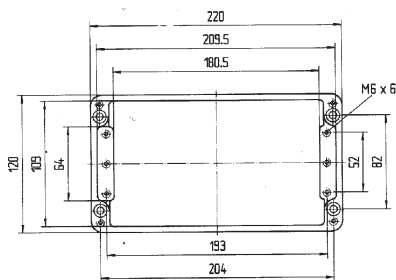

External dimensions: 220 x 120 x 90 mm

Weight: 1040 g
 Material: polyester, grey, black
 Article no.: 07-51 -2201/2090

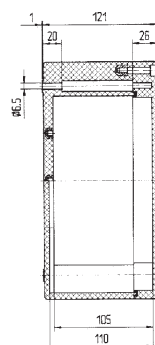
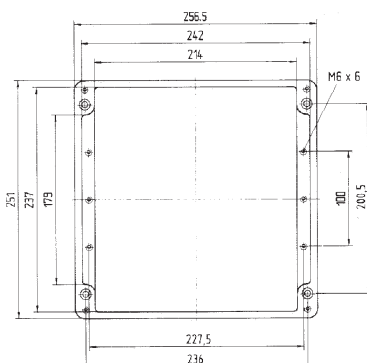

External dimensions: 255 x 250 x 120 mm

Weight: 2700 g
 Material: polyester, grey, black
 Article no.: 07-51 -2552/5012



Dimensions (mm)

The dimensions indicated on this page apply to the following polyester enclosures and distribution boxes:

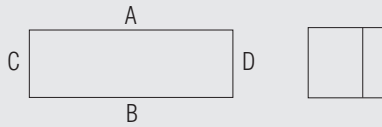

<i>IP enclosure</i>	<i>black</i>	<i>07-5195-.../...</i>	<i>EEx e distribution box</i>	<i>black</i>	<i>07-5103-.../...</i>
<i>IP enclosure</i>	<i>grey</i>	<i>07-5194-.../...</i>	<i>EEx e distribution box</i>	<i>grey</i>	<i>07-5106-.../...</i>
<i>Ex enclosure</i>	<i>black</i>	<i>07-5185-.../...</i>	<i>EEx i distribution box</i>	<i>black</i>	<i>07-5105-.../...</i>
<i>Ex enclosure</i>	<i>grey</i>	<i>07-5184-.../...</i>	<i>EEx i distribution box</i>	<i>grey</i>	<i>07-5107-.../...</i>
<i>IP distribution box</i>	<i>black</i>	<i>07-5178-.../...</i>			
<i>IP distribution box</i>	<i>grey</i>	<i>07-5177-.../...</i>			

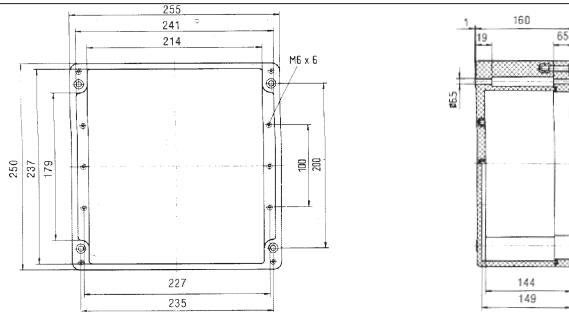

➤ **Technical data**

External dimensions: 255 x 250 x 160 mm

Weight: 3275 g
 Material: polyester, grey, black
 Article no.: 07-51 -2552/5016

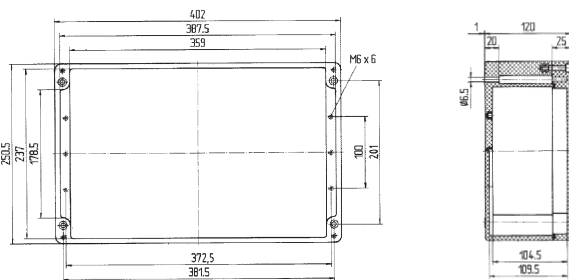

External dimensions: 400 x 250 x 120 mm

Weight: 3700 g
 Material: polyester, grey, black
 Article no.: 07-51 -4002/5012

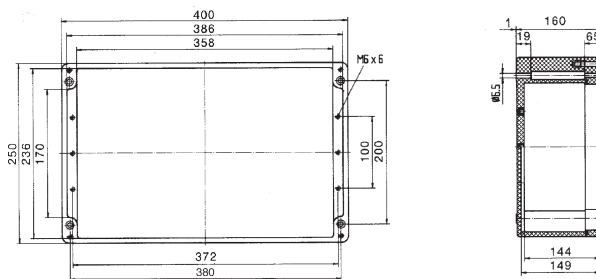

External dimensions: 400 x 250 x 160 mm

Weight: 4800 g
 Material: polyester, grey, black
 Article no.: 07-51 -4002/5016

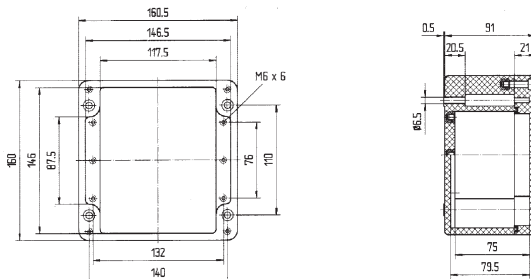

External dimensions: 160 x 160 x 90 mm

Weight: 1280 g
 Material: polyester, grey, black
 Article no.: 07-51 -1601/6090

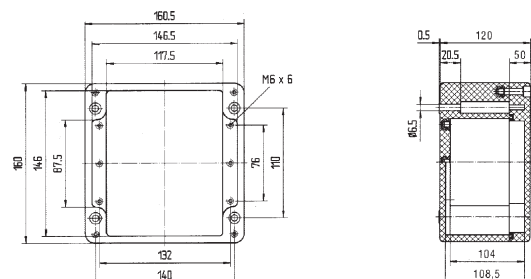

External dimensions: 160 x 160 x 120 mm

Weight: 1500 g
 Material: Polyester, grey, black
 Article no.: 07-51 -1601/6012



Dimensions (mm)

The dimensions indicated on this page apply to the following polyester enclosures and distribution boxes:

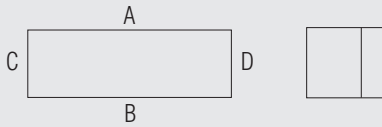

<i>IP enclosure</i>	<i>black</i>	<i>07-5195-.../...</i>	<i>EEx e distribution box</i>	<i>black</i>	<i>07-5103-.../...</i>
<i>IP enclosure</i>	<i>grey</i>	<i>07-5194-.../...</i>	<i>EEx e distribution box</i>	<i>grey</i>	<i>07-5106-.../...</i>
<i>Ex enclosure</i>	<i>black</i>	<i>07-5185-.../...</i>	<i>EEx i distribution box</i>	<i>black</i>	<i>07-5105-.../...</i>
<i>Ex enclosure</i>	<i>grey</i>	<i>07-5184-.../...</i>	<i>EEx i distribution box</i>	<i>grey</i>	<i>07-5107-.../...</i>
<i>IP distribution box</i>	<i>black</i>	<i>07-5178-.../...</i>			
<i>IP distribution box</i>	<i>grey</i>	<i>07-5177-.../...</i>			

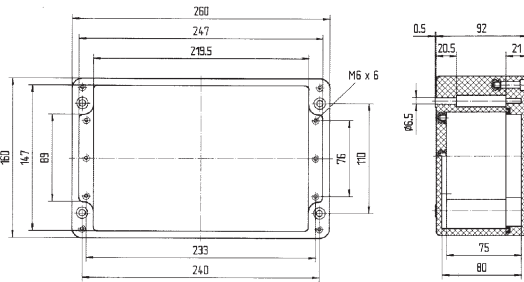

Technical data

External dimensions: 260 x 160 x 90 mm

Weight: 1750 g
 Material: polyester, grey, black
 Article no.: 07-51 -2601/6090

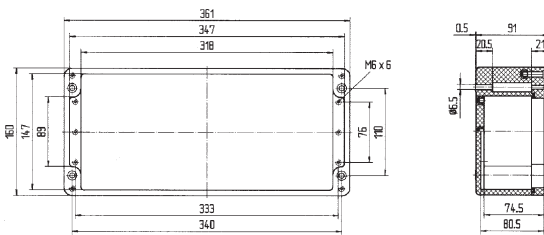

External dimensions: 360 x 160 x 90 mm

Weight: 2300 g
 Material: polyester, grey, black
 Article no.: 07-51 -3601/6090

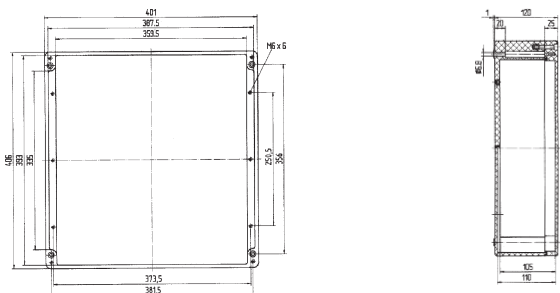

External dimensions: 400 x 405 x 120 mm

Weight: 5100 g
 Material: polyester, grey, black
 Article no.: 07-51 -4004/0512

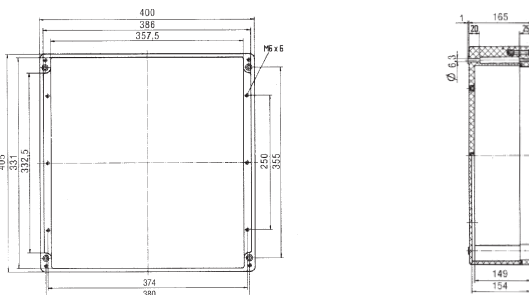

External dimensions: 400 x 405 x 165 mm

Weight: 7740 g
 Material: polyester, grey, black
 Article no.: 07-51 -4004/0516

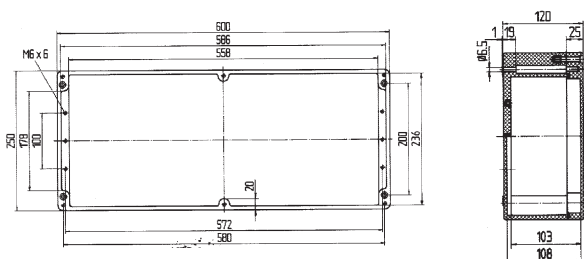

External dimensions: 600 x 250 x 120 mm

Weight: 5380 g
 Material: polyester, grey, black
 Article no.: 07-51 -6002/5012